



APPROVED	DATE	BY	CHECKED	DATE
8/7/13, 100				

KEY

- Existing Carriageway
- Existing Footway
- New Buff Coloured High Friction Surfing
- New Red Coloured High Friction Surfing
- New Coloured High Friction Surfing
- New LED Halo Beisha Beacon

DRAFT Drawing
For consultation only

TORBAY COUNCIL

DATE: 13/09/12
BY: August 2011

ST. MICHAEL'S, PAIGNTON
TRAFFIC ACTION ZONE
CONSULTATION

DRAWING TITLE
TOTNES ROAD
ZEBRA CROSSING UPGRADE

8/7/13, 100

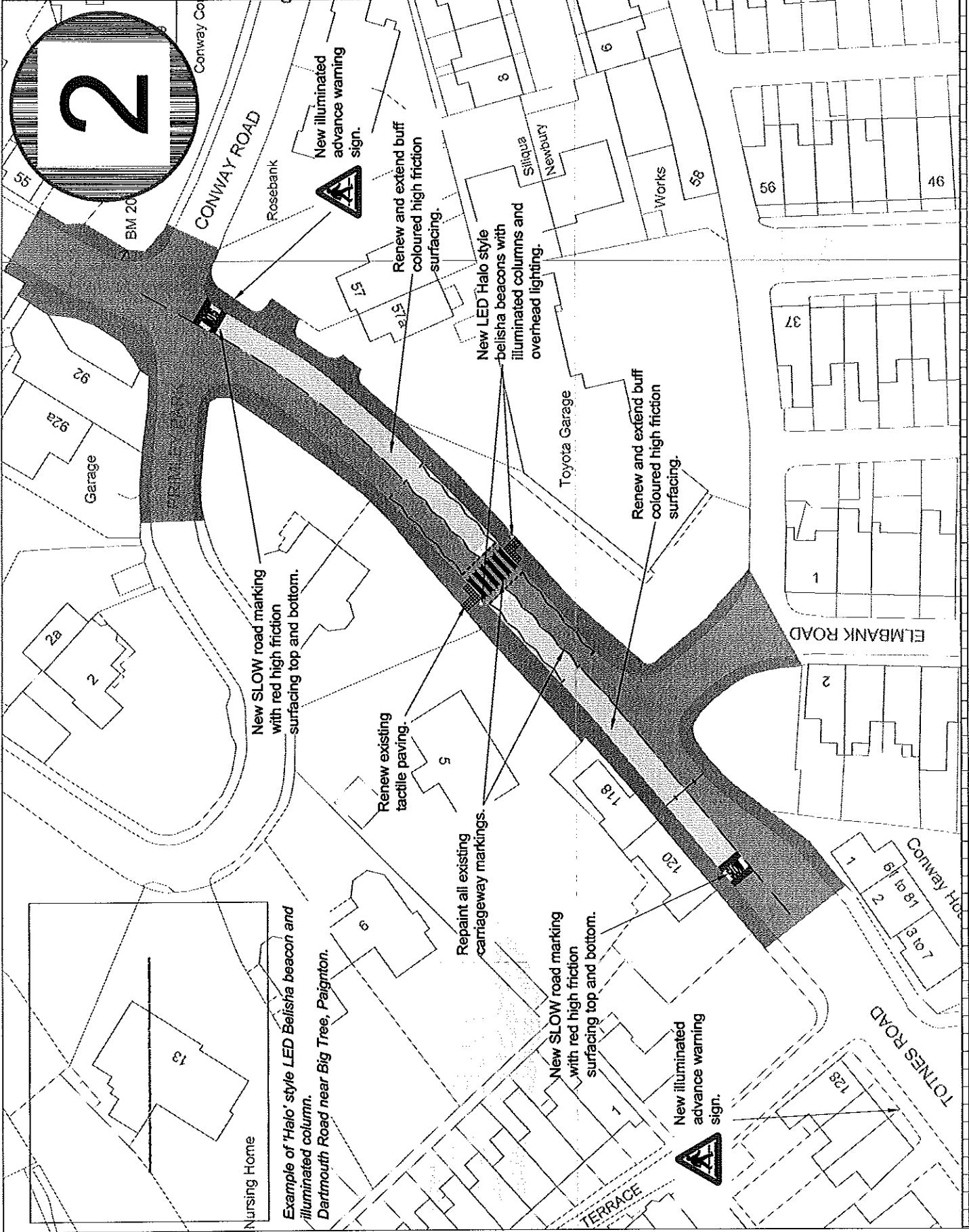

Nursing Home

Example of 'Halo' style LED Beisha beacon and illuminated column.
Dartmouth Road near Big Tree, Paignton.

New illuminated advance warning sign.

Renew and extend buff coloured high friction surfacing.

New LED Halo style beisha beacons with illuminated columns and overhead lighting.

Renew and extend buff coloured high friction surfacing.

New SLOW road marking with red high friction surfacing top and bottom.

Renew existing tactile paving.

Repaint all existing carriageway markings.

New SLOW road marking with red high friction surfacing top and bottom.

New illuminated advance warning sign.

DATE	BY	REVISION

87/13_400

NOTES

KEY

- Existing Carrieway
- Building Footway
- New Gull Covered High Friction Surfing
- New Red Coloured High Friction Surfing
- New Footway Resurfacing
- Flat Top Road Hump (75mm High)
- Carrieway Markings

DRAFT Drawing
For consultation only

This drawing has been prepared by Torbay Council on behalf of the Council of the Borough of Torbay. It is the property of the Council and is not to be used for any other purpose without the written consent of the Council. The Council does not accept any liability for any loss or damage, whether direct or indirect, arising from the use of this drawing.

2501
August 2011

TORBAY COUNCIL

SUB CONSULTANTS
PLANNING, RESIDENTS & VISITOR SERVICES,
ROBERT HOUSE,
ABBOT ROAD,
TORQUAY,
TQ2 7JY

ST. MICHAEL'S, PAIGNTON
TRAFFIC ACTION ZONE
CONSULTATION

DRAWING TITLE

ST. MICHAEL'S ROAD &
ELMBANK ROAD
PEDESTRIAN FACILITIES

87/13_400

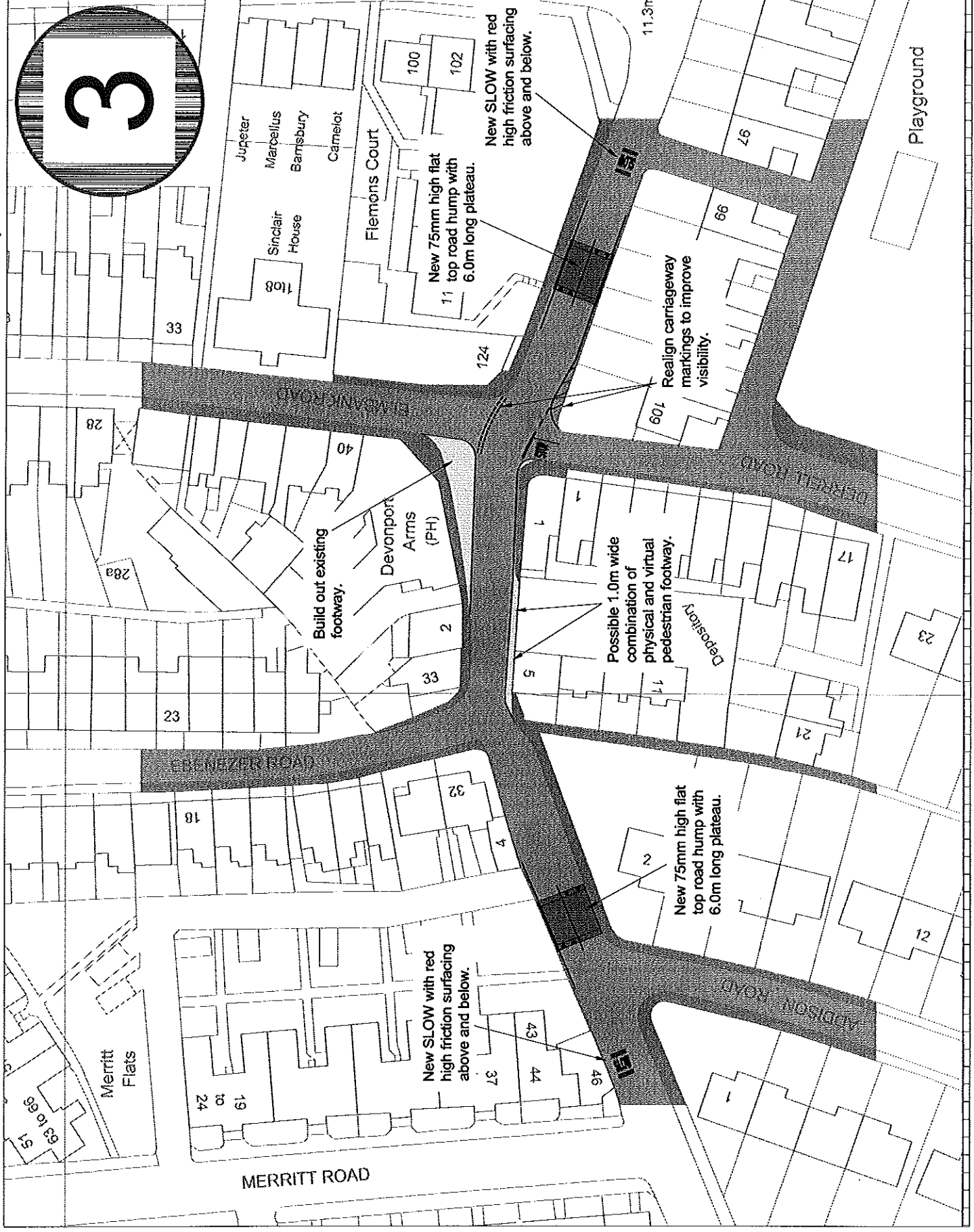
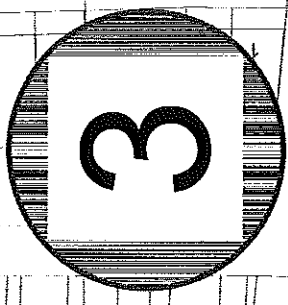

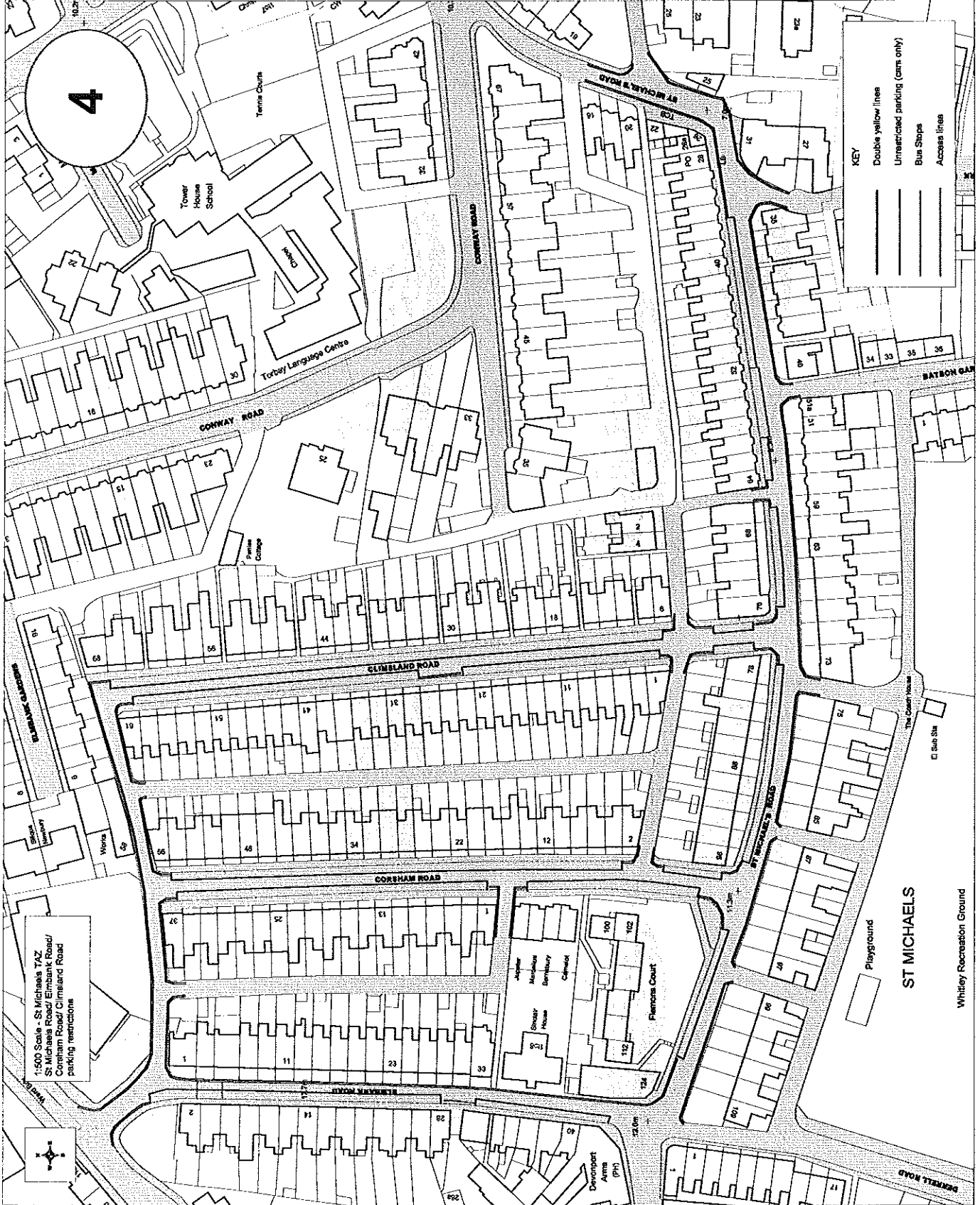

4

1:500 Scale - St Michaels TAZ
 St Michaels Road/ Elmbank Road/
 Corsham Road/ Cinsland Road
 parking restrictions

KEY
 Double yellow lines
 Unrestricted parking (cars only)
 Bus Stops
 Access lines

ST MICHAELS
 Whitley Recreation Ground

DATE	DESCRIPTION
8/7/13	200

LEGEND

- Existing Carriageway
- Existing Footway
- New Buff Coloured High Friction Surfing
- New Red Coloured High Friction Surfing
- New Footway Reconstruction
- New Top Road Hump (Down Hill)
- Carriageway Markings

DRAFT Drawing
For consultation only

TORBAY COUNCIL

PLANNING AND DEVELOPMENT SERVICES
COUNCIL HOUSE
ABBOT ROAD
TORQUAY
TQ2 7JP

ST. MICHAEL'S, PAIGINTON TRAFFIC ACTION ZONE CONSULTATION

DRAWING TITLE
ST. MICHAEL'S ROAD & YORK ROAD PEDESTRIAN FACILITIES

8/7/13_200

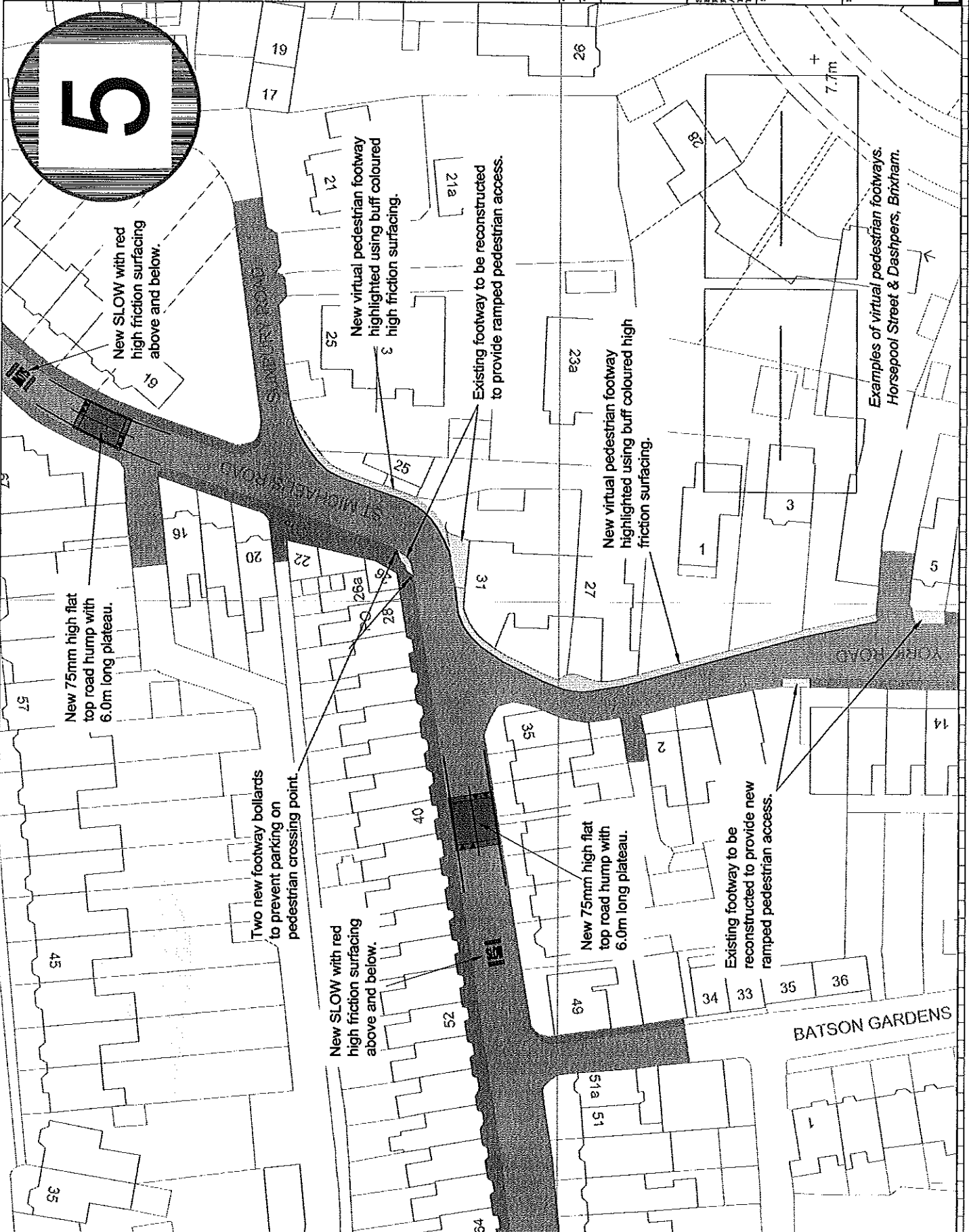

8/7/13_300	
DATE	8/7/13
BY	300
CHECKED	
APPROVED	

LEGEND

- Existing Compromise
- Existing Footway
- New Footway
- Existing Compromise Markings

DRAFT Drawing
For consultation only

Copyright © 2011 Torbay Council. All rights reserved. This drawing is the property of Torbay Council and is not to be used, copied, reproduced, or distributed without the written consent of Torbay Council. Torbay Council is not responsible for any errors or omissions in this drawing.

DATE: August 2011

TORBAY COUNCIL

SUE CHRISTON
EXECUTIVE HEAD
TRAFFIC AND TRANSPORT SERVICES
ROBERTS HOUSE
ABBAY ROAD,
TORQUAY,
TOR 2 27F

SCHEMATIC TITLE:
**ST. MICHAEL'S, PAIGNTON
TRAFFIC ACTION ZONE
CONSULTATION**

DRAWING TITLE:
**FISHER STREET &
SUNBURY ROAD
JUNCTION IMPROVEMENTS**

8/7/13_300

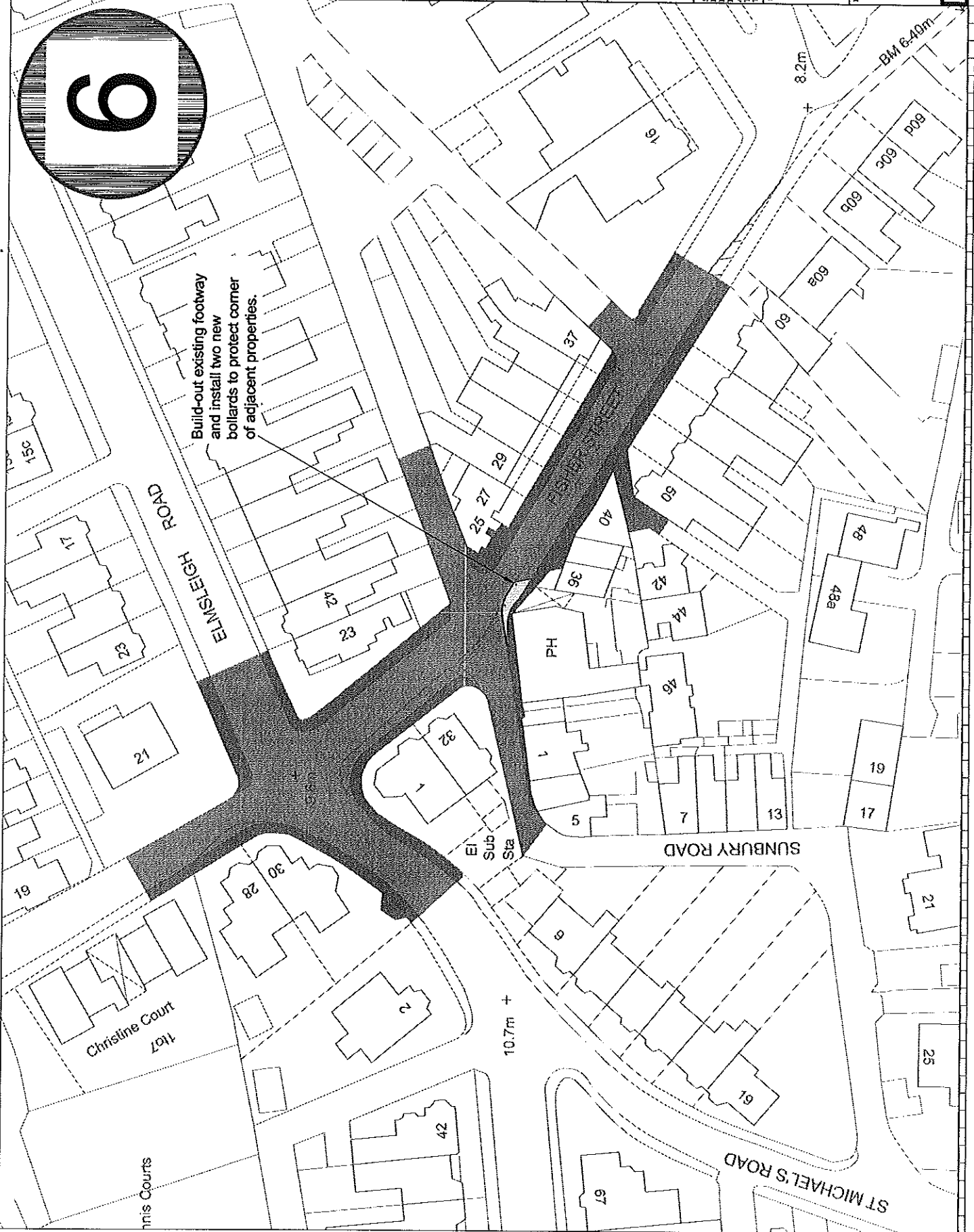
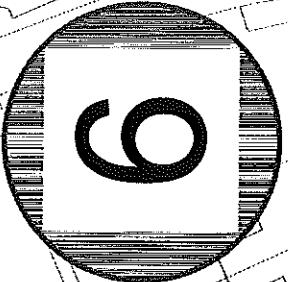

1:500 scale - St Michaels TAZ-
Whitley Road - Parking Restrictions



7

WHITLEY ROAD

6

12

23

21

18

54

52

48

44

KEY



Proposed no waiting
at any time

Allotment Gardens

1:1000 scale - St Michaels TAZ
Broadlands Road/ Footland Road
- Parking Restrictions

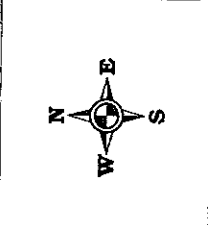

8

KEY

Proposed no waiting
at any time.

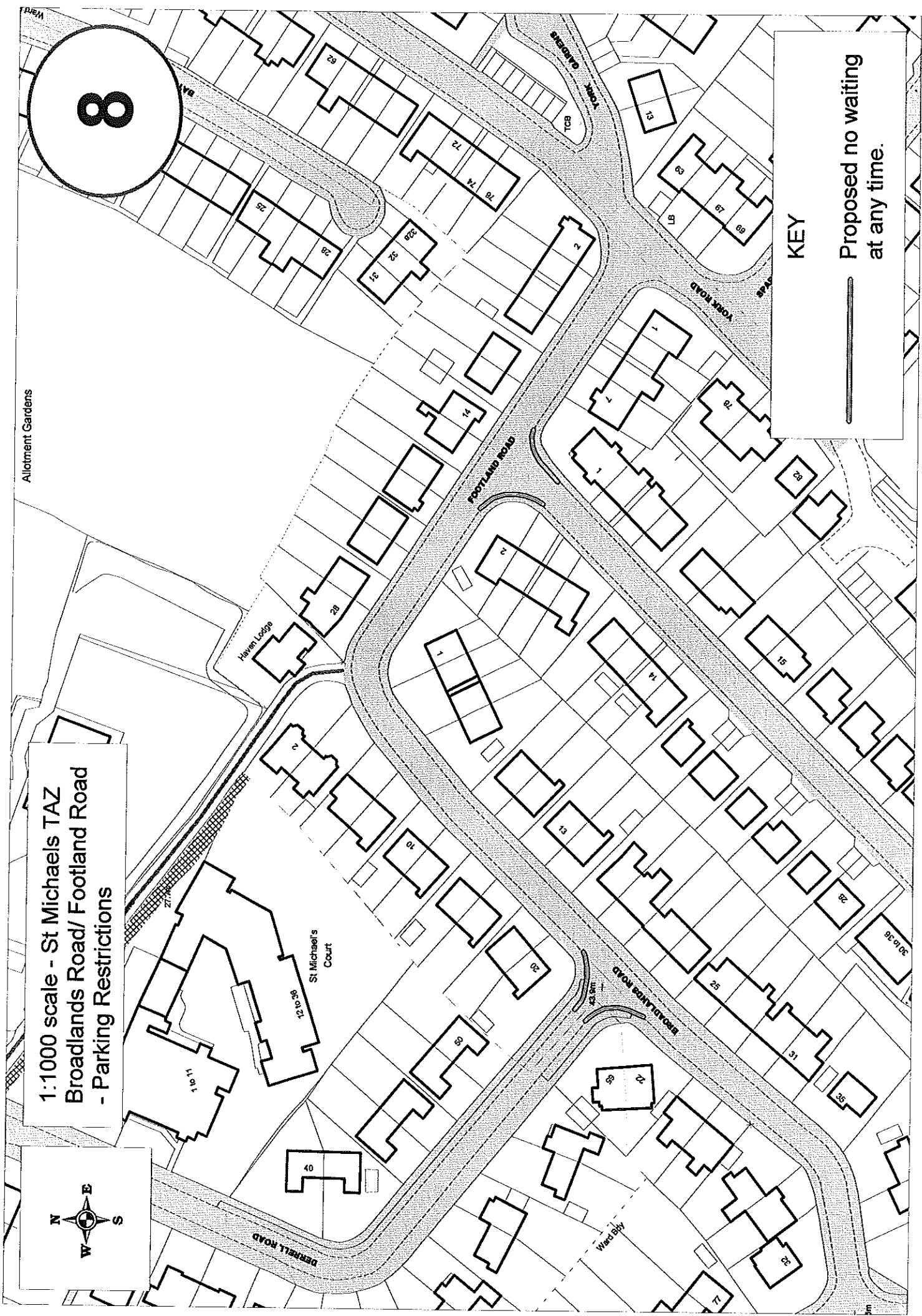

9

1:1000 scale - St Michaels TAZ
Clennon Rise parking restrictions

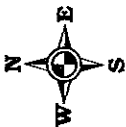

KEY

Current no waiting at any time.

Proposed no waiting at any time.

Proposed no waiting 8am-6pm

